

REMARKS: Consider that the pressure value got just after the time when the sensor was put on a human skin was indicated to read 1.2 kPa while the maximum pressure value got at the time of pressure test reading 20 kPa. On that occasion, the pressure measuring range of our system will have to be noted to be 1.2 kPa to 20kPa. Never deduct the pressure value of 1.2 kPa from the maximum measurement value because, if you do so, the value indicated may come lower from the correct value by 1.2 kPa. Desregard the value of 1.2 kPa because the Air-pack sensor itself has already made arrangements for avoiding deduction.

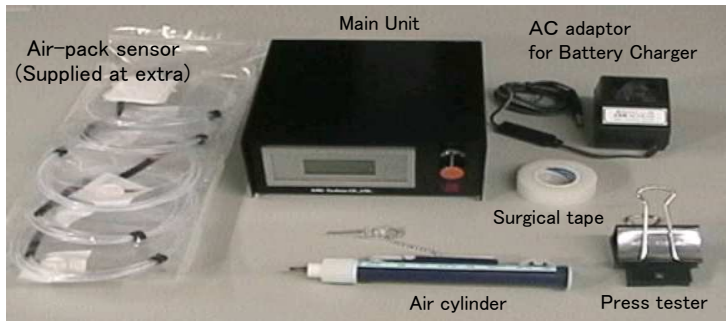

12) Mounting Air-pack sensor under approximate pressure from 0.1 to 0.3 kPa avoiding an excessive pressure applied.

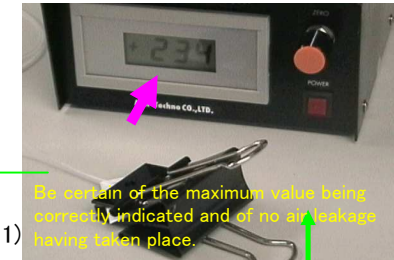

Disconnect the Air-pack sensor picking this portion up tightly finger tip.

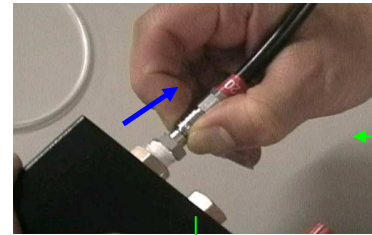

2) Operate the system while connecting the AC Adaptor to the system if the alarm lamo das lit up

Charge Alarm Lamp



AMI Techno Co., Ltd.
 E-mail: ami-tec@m2.pbc.ne.jp
<http://www.ami-tec.co.jp/>

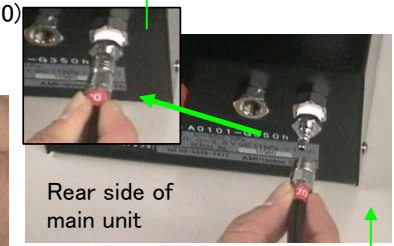
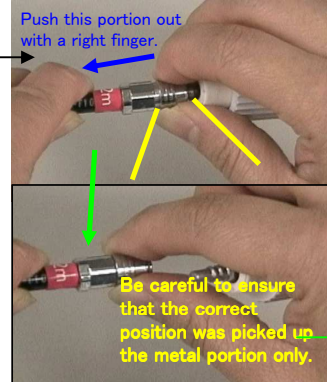
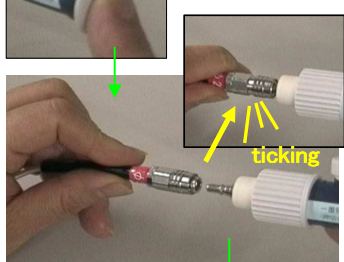
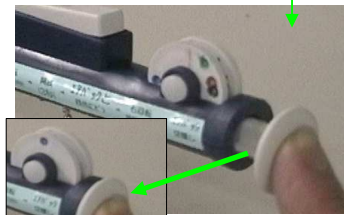

Release the mechanism while watching that the rotational gear not go back at this point.